

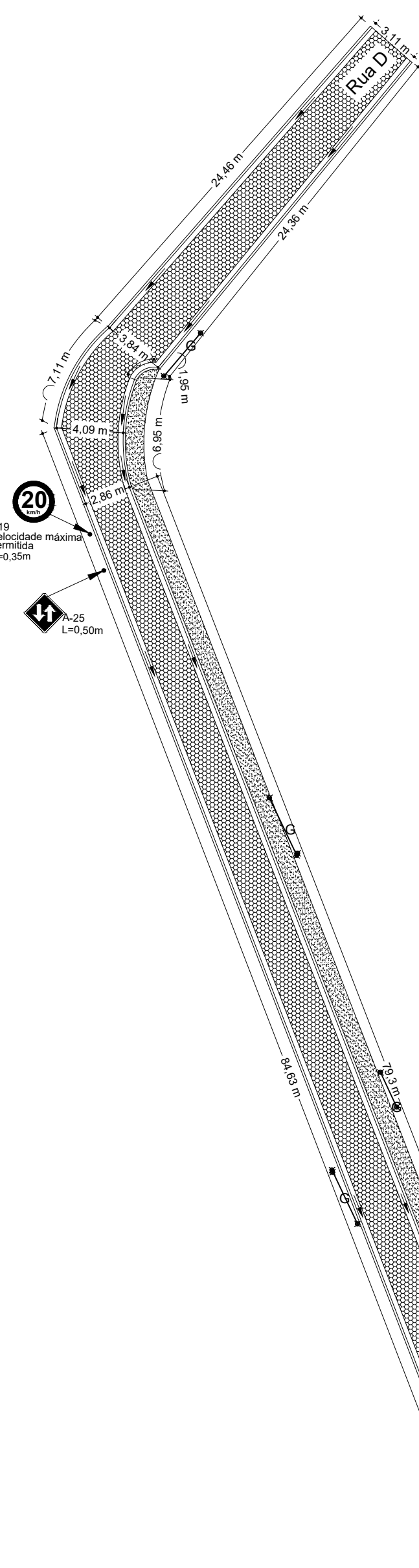

A circular speed limit sign with a black border. Inside the circle, the number '20' is written in large, bold, black digits. Below the number, the text 'km/h' is written in a smaller, black, sans-serif font.

 DETALHE PARA LOCAÇÃO DAS PLACAS
Sem Escala

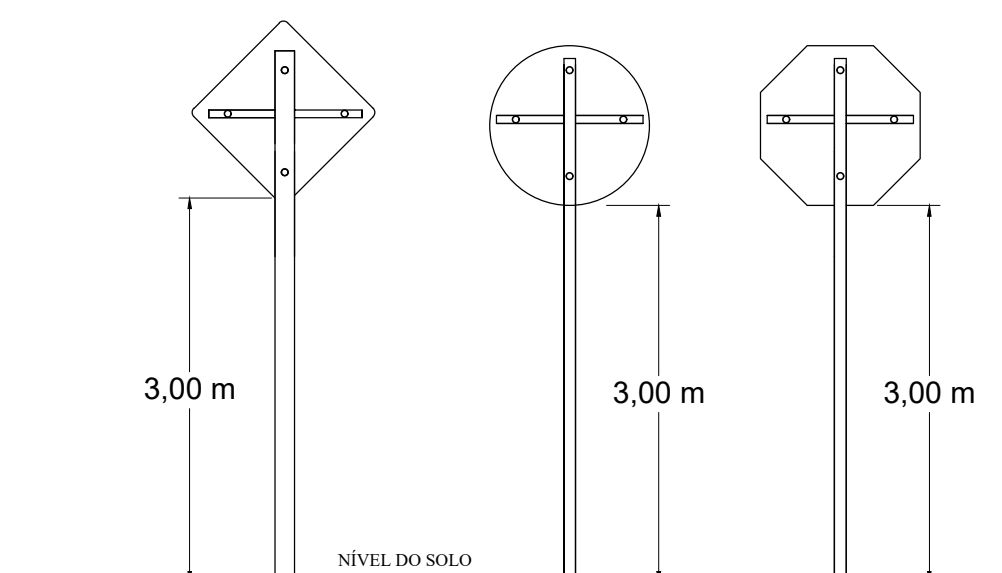
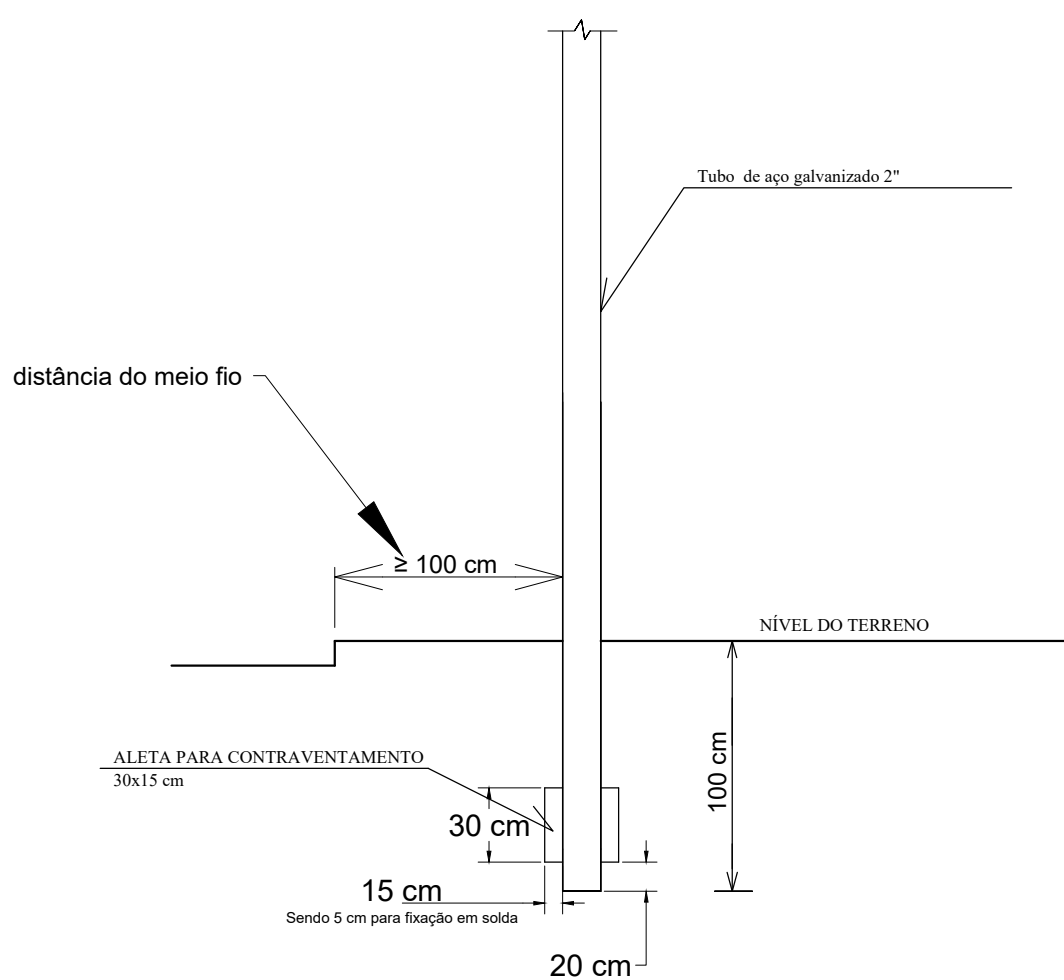
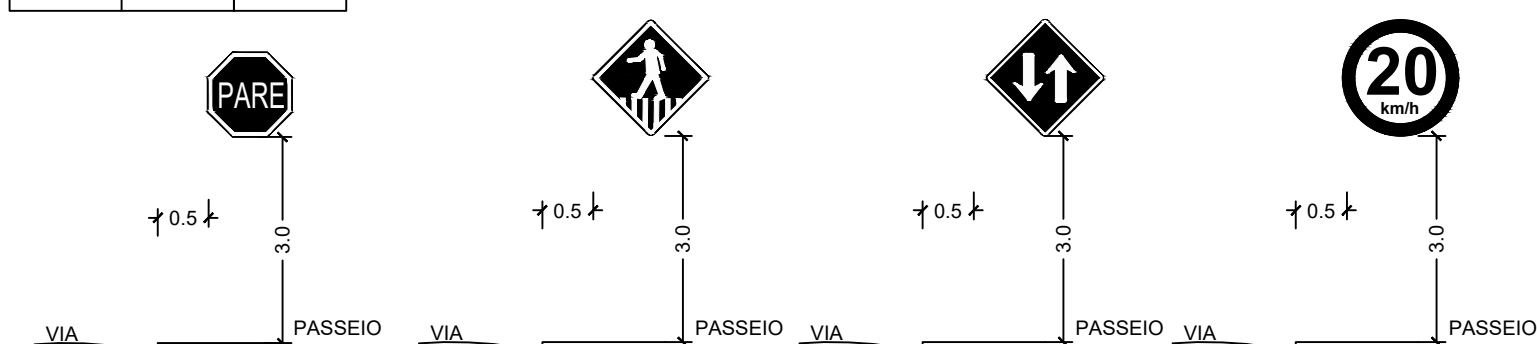
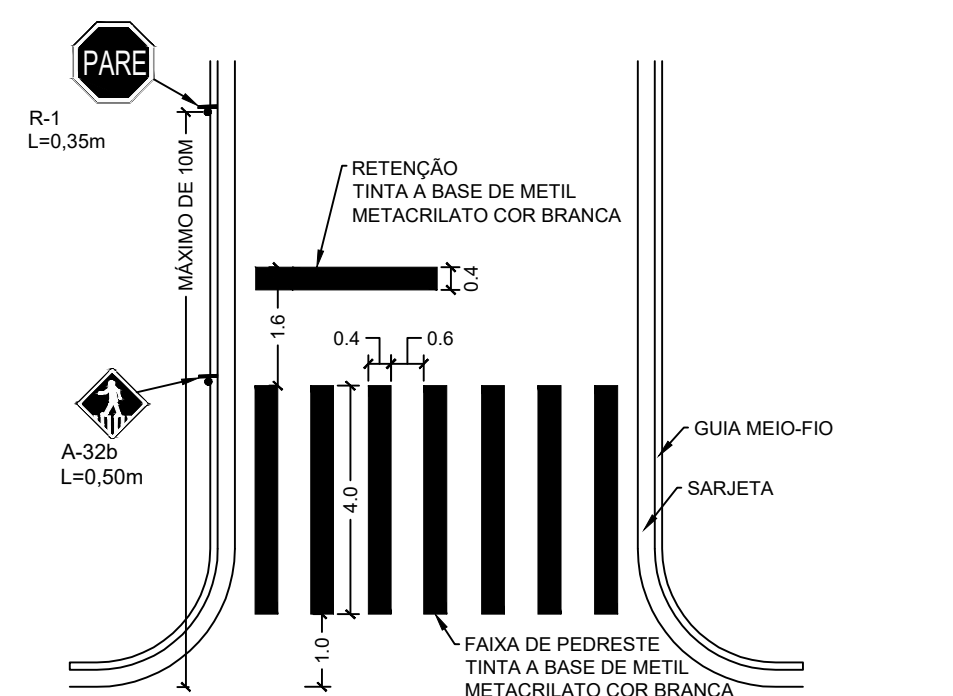
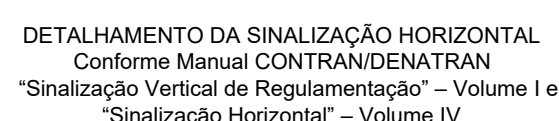
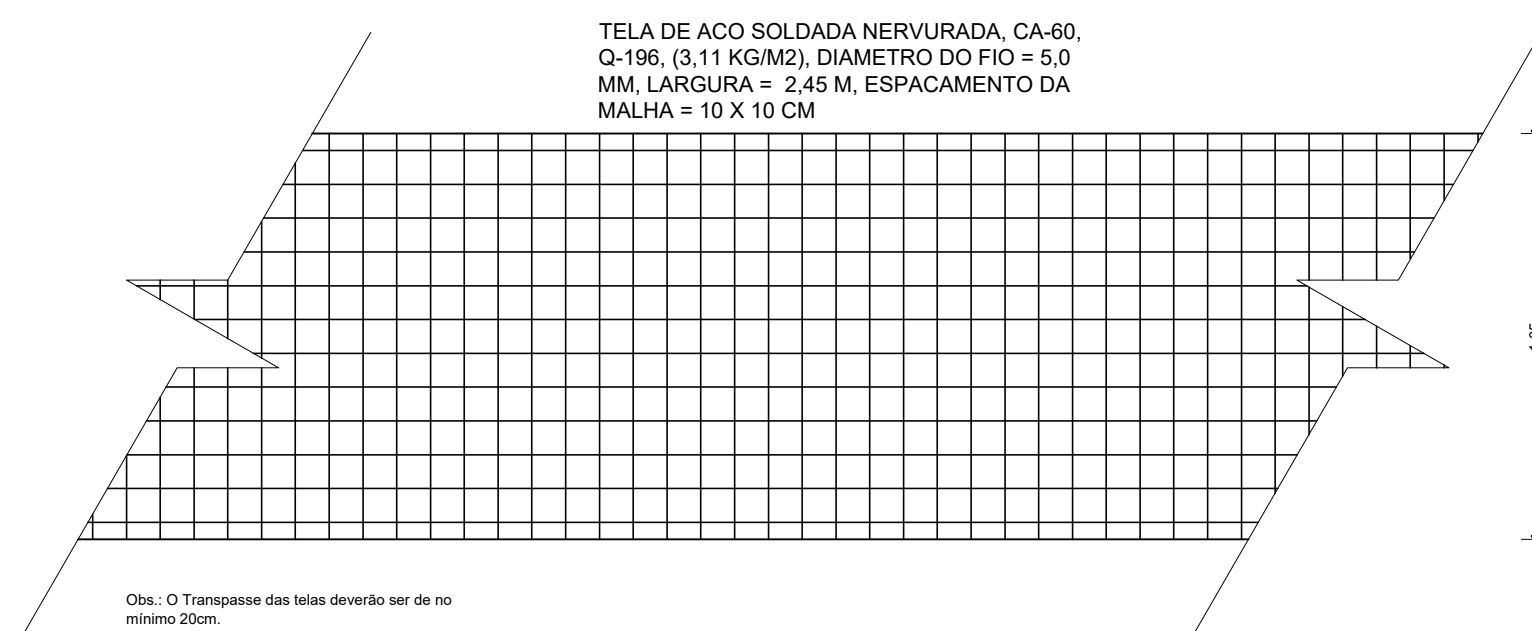
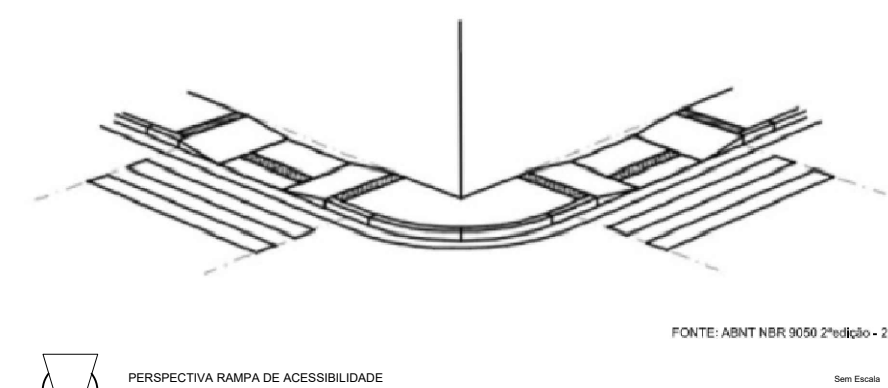
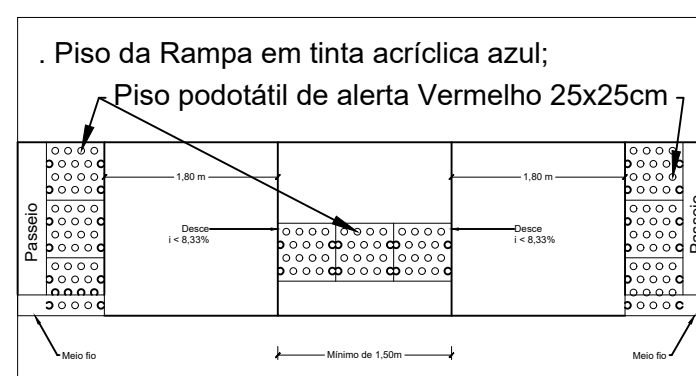

 DETALHE DA FAIXA DE PEDESTRE E SINALIZAÇÃO
Sem Escada



 Detalhe da armação das calçadas
Sem Escala

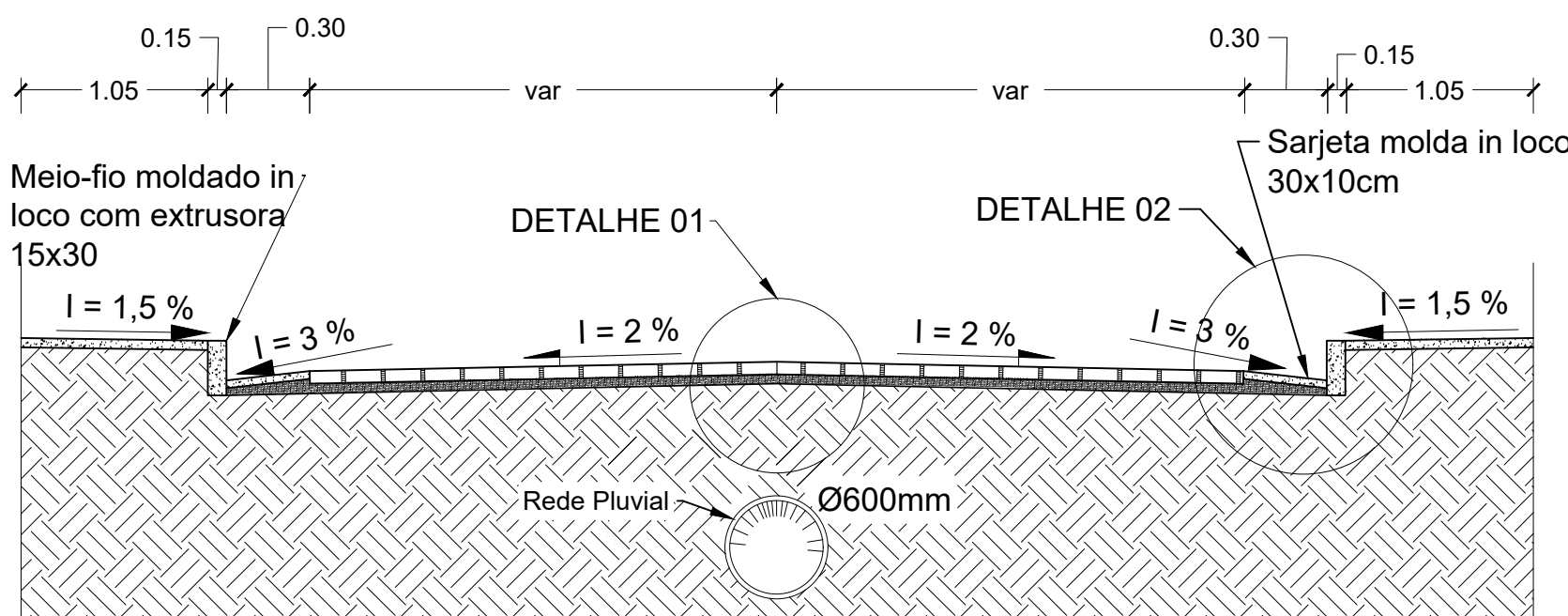
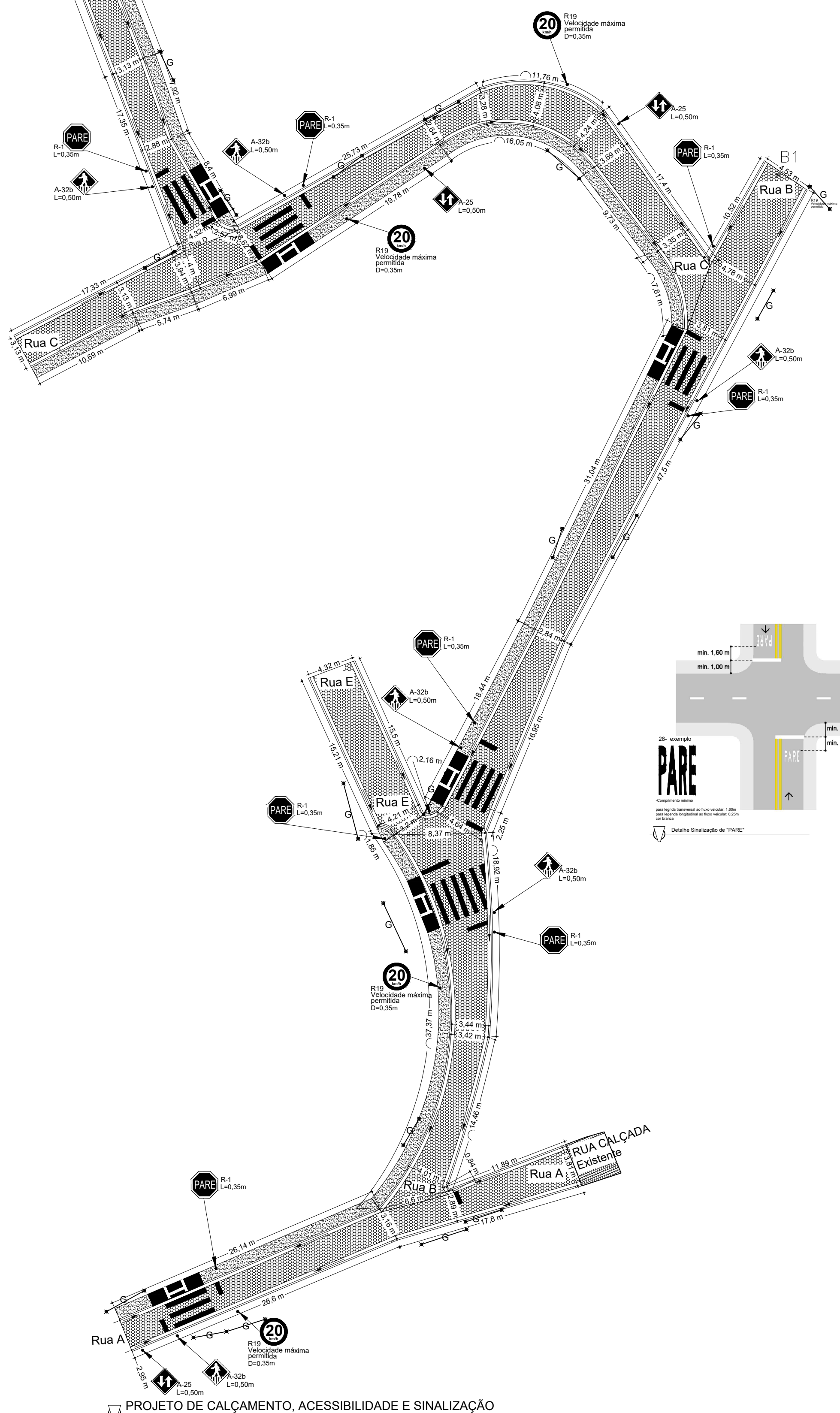

SEÇÃO TRANSVERSAL TÍPICA COM REDE PLUVIAL Sem Escala

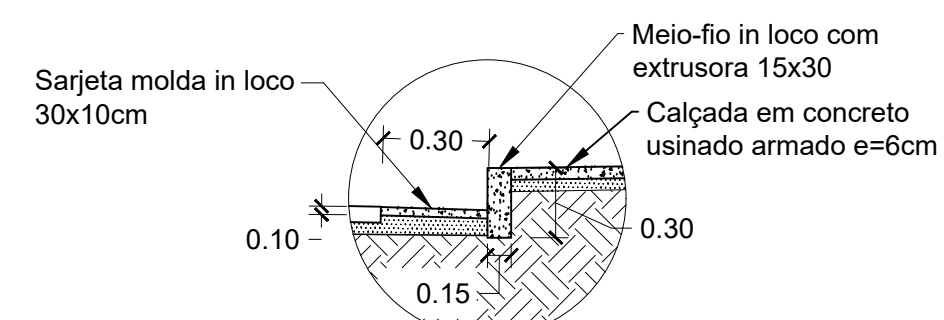

DETALHE 02 Sem Escala

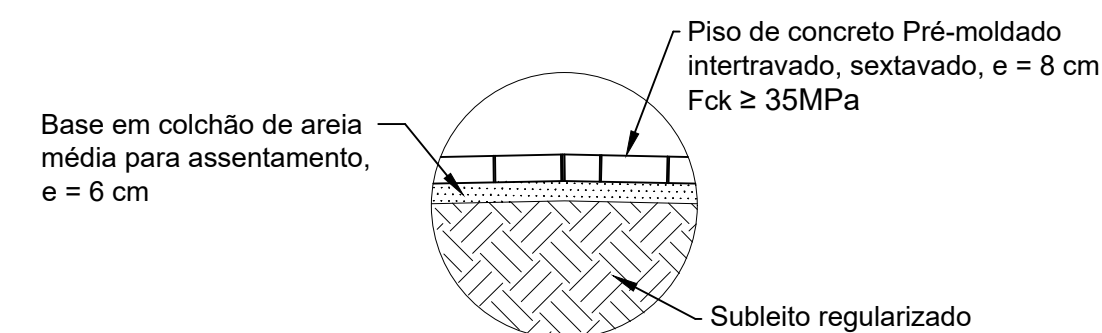

DETALHE 01 Sem Escala

Tabela de Quantitativos				
RUA	PASSEIO (m²)	MEIO-FIO (m)	SARJETA (m)	CALÇAMENTO (m²)
A	27,51	82,43	82,43	111,52
B	91,45	200,46	200,46	346,88
C	79,60	149,01	149,01	220,85
D	110,06	265,00	265,00	339,72
E	0,99	32,56	32,56	57,98
TOTAIS	309,61	729,46	729,46	1076,95

OBJETO - EXECUÇÃO DE OBRAS DE PAVIMENTAÇÃO					
Endereço:					
VILA TEODORICO, DIVINO-MG					
Descrição da obra:					Folhas:
Pavimentação de vias urbanas					01/03
CONVÊNIO:	Agente financeiro ou Ag. Operador Repasse / Fonte de recurso:				Escala
884429/2019	CAIXA / MINISTÉRIO DAS CIDADES / OGU				indicada
Conteúdo:	ART			Data:	
PROJETO DE CALÇAMENTO			142020000000005982332	26/08/2021	
Proprietário:			Responsável Técnico:		
_____ Prefeitura Municipal de Divino-MG Mauri Ventura do Carmo			_____ Engenheiro Civil - CREA-MG: 224.002/D Keverton Oliveira Silva		
Órgãos complementares:					